

REV	MCR #	DESCRIPTION	DWN	APRV	DATE
A	3864	ITEM 3 ADDED 'INPUT' TO DESCRIPTION. ITEM 7: ADDED 'OUTPUT' TO DESCRIPTION.	MM	--	---
B	4238	ADDED ITEM 8 TO L/H & F/D.	MM		09/20/01

NOTES:

1. THIS KIT IS TO BE USED ON THE OLD AND NEW STYLE COMPRESSOR. THIS DOCUMENT REFLECTS THE NEW STYLE COMPRESSOR.
2. DEPENDING ON THE AGE OF THE COMPRESSOR, CONNECTING ROD SECTION MAY VARY PICTORIALLY.

REMOVAL:
 LOOSEN FOUR CYLINDER BOLTS AND REMOVE MANIFOLD AND VALVE PLATE.
 REMOVE O-RINGS (ITEMS 1 & 2), SPRINGS (ITEMS 3 & 7), AND VALVES (ITEMS 4 & 5).
 REMOVE O-RING (ITEM 6) FROM VALVE PLATE.

INSTALLATION:
 INSTALL NEW O-RING (ITEM 6) INTO VALVE PLATE. INSTALL NEW VALVES (ITEMS 4 & 5) WITH NEW SPRINGS (ITEMS 3 & 7) ONTO VALVE PLATE. INSTALL NEW O-RINGS (ITEMS 1, 2 & 8). ASSEMBLE VALVE PLATE BETWEEN CYLINDER BODY AND MANIFOLD. INSTALL FOUR CYLINDER BOLTS AND TIGHTEN IN A CROSS-PATTERN. REINSTALL COMPRESSOR INTO MACHINE. PRESSURE UP MACHINE AND CHECK FOR LEAKS.

Includes:

ITEM	PART NO.	DESCRIPTION	QTY
9	---	---	---
8	SB2005	O-RING	1
7	NB5607	OUTPUT VALVE SPRING	1
6	SB2026	#025 O-RING	1
5	CP1009	INPUT VALVE	1
4	CP1010	OUTPUT VALVE	1
3	NB5605	INPUT VALVE SPRING	1
2	SB2013	#013 O-RING	1
1	SB2027	#027 O-RING	1

LIST OF MATERIAL

ATP
 ADVANCED TEST PRODUCTS

TITLE: VALVE REPLACEMENT KIT
 INSTRUCTIONS SHEET FOR KT3303
 (OLD & NEW STYLE COMPRESSOR)

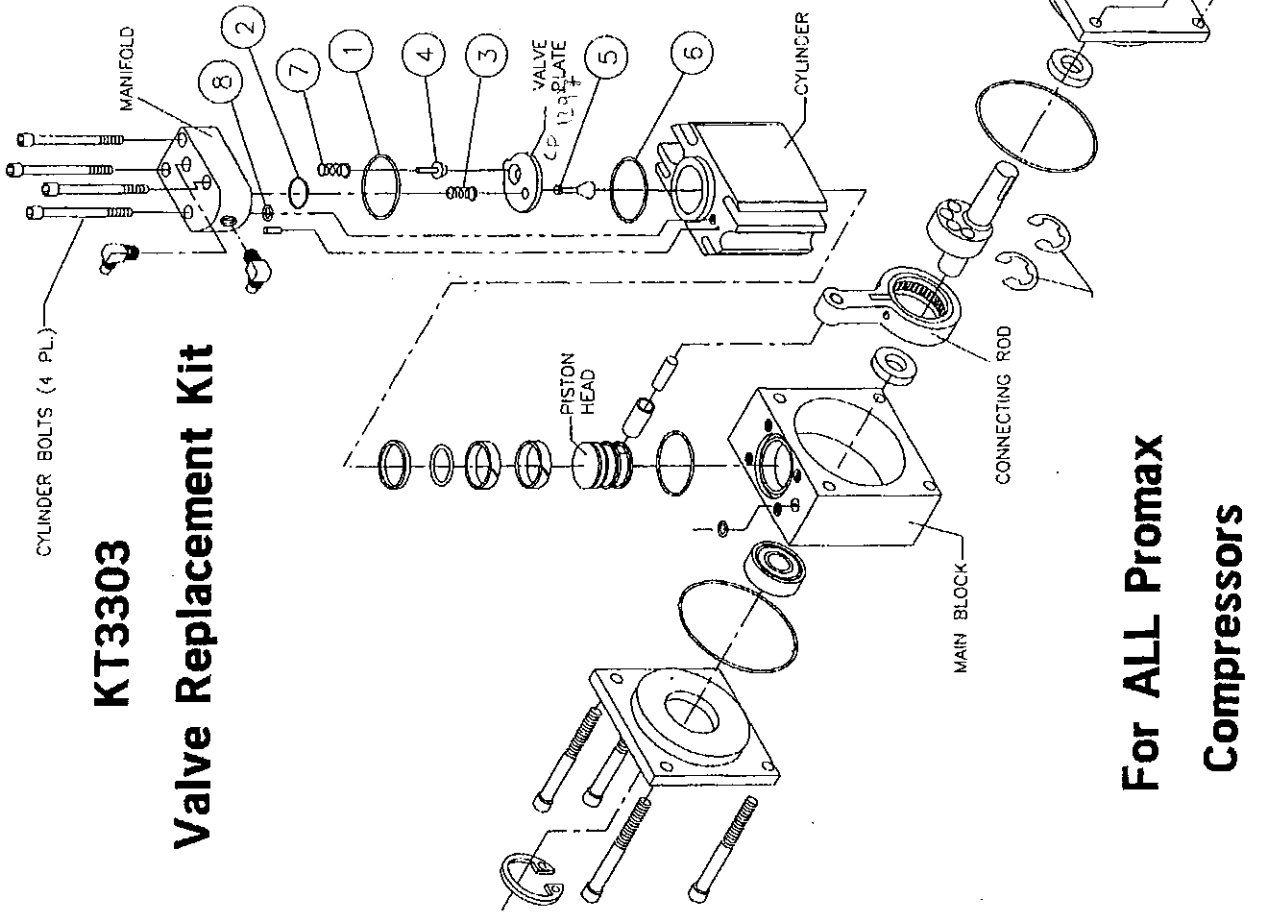

KT3303

Valve Replacement Kit

**For ALL Promax
 Compressors**
 CA1300, CP1300, & CP1320

From Artw\KI5004(